



PanelTrac™

- Installation Instructions
- Warranty
- Care Instructions

PanelTrac™



www.levolor.ca

Thank you for purchasing this high quality shade. Your new PanelTrac™ has been custom made to your window dimensions from the highest quality materials. You can take pride in the fact that your purchase will add functional and fashionable beauty to your home. Your new PanelTrac™ installs in a few easy steps. Please review the instructions completely before installing your shade. Please read the warning information included in these instructions and with your shade.

Step 1 - Getting Ready

Remove the PanelTrac™ from the packaging. Tools you may need to install your shades; pencil, #1 and #2 Robertson screwdriver, level, and a drill.

Step 2 - Installing the Brackets

Note: Do not overtighten the screws. The brackets must be loose enough to rotate.

For Inside and Ceiling Mount Applications:

Measure 4" from each end of the track and mark the location of the installation clip on the ceiling with a pencil. A minimum distance of 1" between the track and the wall or obstruction is required for clearance when the installation clip arm is the open position. (See Diagram) Space the additional installation clips evenly between the 2 end clips and install them.



Ceiling Clip

For Wall Mount Application:

Measure 4" from each end of the track and mark the location of the installation bracket on the wall with a pencil. Make sure that the brackets are level with each other. Space the additional installation brackets evenly between the 2 end brackets and install them.

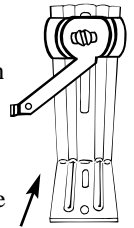

Wall Bracket

Step 3 - Installing the Track

With the brackets installed, place the track onto the brackets. The bracket arms may have to be rotated slightly to allow the track to fully engage the brackets. Start in the center and push the track straight up into the brackets. Rotate the bracket arms to the closed position. (Diagram B)

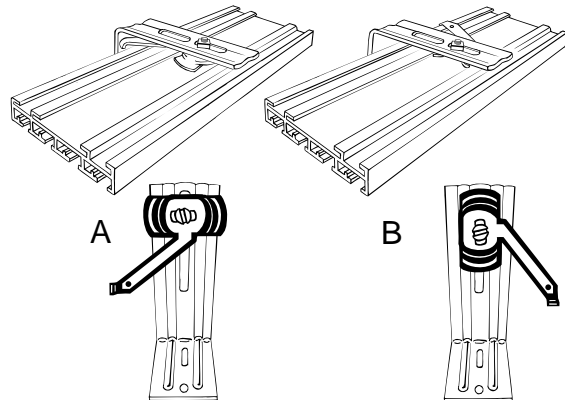

Arm in open position

Arm in closed position

Step 4 - Installing The Valance - optional

Cornice Valance:

Insert the clip on the back of the cornice valance into the valance clip attached to the track. Rotate to the flat position to lock into place.

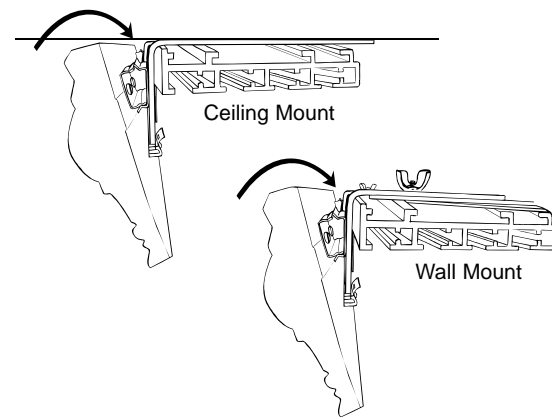

Decorative Wood Valance:

Note: Decorative Wood Valance brackets should be flush with the ends of the headrail

- 1) Mount the wood valance brackets so that the top of the wood bracket is even with the top of the track.
- 2) To Mount the brackets:
 - a. To ensure you are mounting the brackets flush to the track measure the width of the bracket, and use the midpoint measurement as you vertical guide to install the mounting plate.
 - b. To locate the top of where the mounting plate will be installed, measure 1/8" below the top of the track. From your midpoint, mark and pre-drill the hole.
 - c. Loosen the screws on the back of the bracket and push the mounting plate towards the top of the bracket, hold in place until measurements are taken.
 - d. Measure the distance from the top of the bracket to the center screw hole.
 - e. Detach the mounting plate from the valance bracket. Mark and pre-drill the bottom hole.
 - f. Attach the mounting plate and then the wood valance.
 - g. Repeat the above steps for the other wood valance bracket.
- 3) Screw the finials onto each end of the pole. Place the pole on the valance brackets and position it so that it hangs evenly over the brackets at each end.

If PanelTrac™ is wider than 68" you will need to anchor the pole to the center support, as follows:

- 1) Locate the center of the center support bracket and place a mark on the pole at that location. Take the pole down.
- 2) Pre-drill the spot you marked and using the supplied screw anchor the pole to the center support bracket.
- 3) Put the pole back up and assemble the two pieces of the center support bracket.

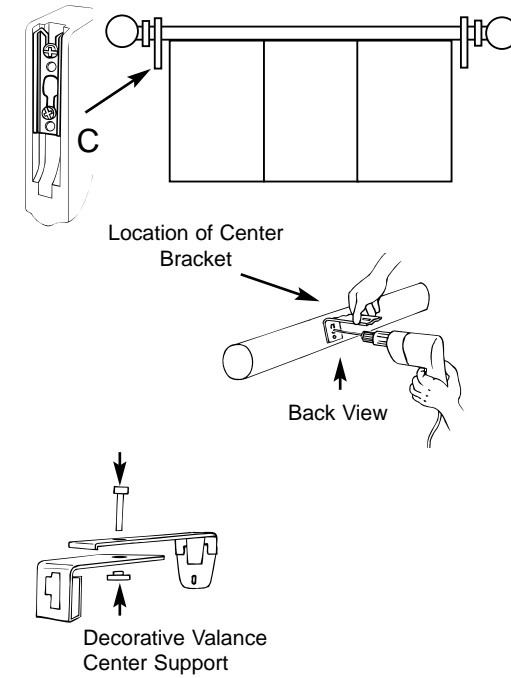

Step 5 - Installing The Tension Device

The tension device can be mounted to the wall for outside mounts or to the window sill for inside mounts. Choose the position for your application. Make sure that the draw cord moves freely through the device. Attach with the screws provided.



Step 6 - Installing The Panels

Draw the cord so that all carriers are independent of each other blind in a closed position. This will make it much easier to install the panels onto the Velcro strips. Do not unroll the panels when installing. Keeping them in a rolled position allows for easy handling and installation. Starting with the back panel, align the Velcro strip on the panel with the Velcro strip on the carrier. Start at one end and press the Velcro strips together for a secure attachment.

Repeat for all remaining panels.

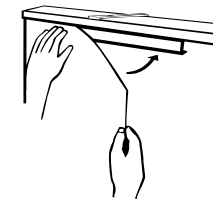

Step 7 - Operating Your PanelTrac™

To traverse the panels, pull the draw cord to move the panels to the desired position.

Care and Maintenance

Minimal care and cleaning is needed to maintain the beauty of your PanelTrac™.

To Dust; use a soft clean cloth.

To Vacuum; use soft brush or dust head attachment.



DANGER
STRANGULATION
HAZARD

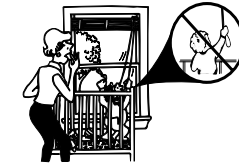

Keep cords out of the reach of children

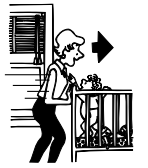

Move cribs and furniture away from cords

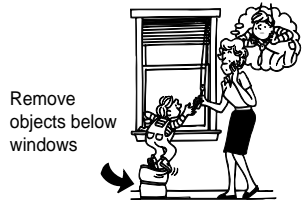

Remove objects below windows



Loops will appear when shade is in raised position



Do not tie cords together



Install the tension device supplied



EMERGENCY FIRST AID FOR STRANGULATION



- Remove cord from child's neck
- Call 911 or Emergency Center
- Clear throat
- Check breathing and heart beat
- Begin CPR

LEVOLOR® LIFETIME LIMITED WARRANTY

Levolor® proudly extends a lifetime limited warranty on the purchased product to the original residential purchaser as long as the product remains in the original window. Levolor® will cover the entire product against manufacturing defects (i.e. a flaw in the product design, materials or workmanship, that cause the product to no longer function). This warranty does not include any conditions or damages resulting from accidents, alterations, misuse, abuse or failure to follow our instructions with respect to measurement, installation, cleaning or maintenance. The Levolor® Lifetime Limited Warranty does not cover damages caused by cleaning methods that use abrasive solutions or ultrasonic cleaning methods. This warranty also does not apply to conditions or damages caused by normal wear and tear upon the product.

The head rail and working components of all our products (except Specialty and Commercial Applications) are covered under the Lifetime Limited Warranty. Cellular and Pleated fabric is covered for a period of 5 years. Roller & PanelTrac™ fabric is covered for a period of 5 years. Vertical PVC vanes are covered for a period of 3 years and fabric vanes are covered for a period of 5 years. Metal Blinds have a limited lifetime warranty on slats. Perceptions® Soft Verticals fabric and PVC vanes are covered for three years. Woven Wood/Natural Shades™ are a natural product and slight imperfections in the finish and colour are normal characteristics. These natural characteristics let you know you are enjoying the authentic item and not an artificial wood imitation. Levolor® cannot guarantee against these natural characteristics of wood, including warpage. Specialty applications and commercial applications are covered for a period of 1 year.

Warranties do not cover removal, installation or shipping costs.

X63400LC